



Owner's Manual

- *Initial Setup*
- *Operating Instructions*
- *Parts Diagram(s)*
- *MSDS Documentation*
- *Contact Information*

ACC Eco Shampoo System

Model: SC – super concentrate



T: 1.800.265.7405 E: info@accint.ca

ACC Eco-Shampoo System (SC)

Initial Setup Instructions

The ACC Eco Shampoo System (SC) is preset to work with the ACC Eco Shampoo Type B or T (super concentrate). The pump automatically mixes the water and shampoo to the correct proportions (128:1).



1. Assemble the ACC Eco Shampoo System as seen in the picture (left).
2. Insert the shampoo boxes into the racks.
3. Connect the small clear plastic hose to the bottom of the pump.
4. Connect the grey valves to the concentrate box (see attached drawings).
5. Open the grey valves on the concentrate boxes by pushing in the protruding piece of the valve, into the valve body
6. Connect the water supply to the hose fitting at the top right of the shampoo system (to the right of the black strainer)
7. Connect the shampoo hose to the lower right hose barb fitting and install a hose clamp to secure it.
8. Connect other end of shampoo hose to hose barb fitting on trigger assembly of the supplied wand.
9. Turn on the water supply and hold open the shampoo wand until the water/shampoo mixture comes out (this will take 1-5 minutes depending on the length of the shampoo hose).
10. When working correctly, the pump unit makes a distinct “click – clack” sound when operating.

IMPORTANT: Do NOT use tools on the pump unit, HAND TIGHTEN ONLY.

ACC Eco Shampoo – Box Connector

Installation Instructions



1. Remove the travel cap from the bag spout. Snap the QC/D connector onto the bag spout as shown.

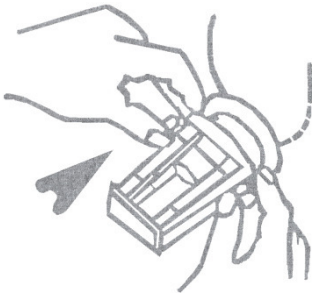

2. Grasp the QC/D connector as shown and push the sliding probe into the bag spout. It will lock into the “in” position. Product is now ready to dispense.

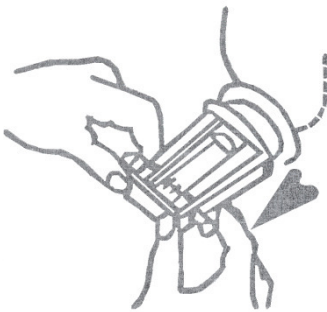

3. To change containers, slide and lock the probe into the “out” position as shown and remove the QC/D connector from the bag spout.

For dispensing, the connector must be locked into the “in” position, as shown in the picture to the right.



ACC Eco-Shampoo System (SC)

General Operating Instructions

1. Apply shampoo by taking the wand and pointing it at the vehicle, keeping the end of the wand approximately three (3) feet from the surface of the vehicle.
2. Start the shampoo application by pulling the trigger on the wand and sweeping the wand left and right in a smooth motion, working your way up from the bottom of the vehicle to the top (to the bottom of the windows on buses).
3. Proceed all the way around the vehicle, from the front side, all the way around the back to the front of the other side, walking at a brisk pace, applying shampoo as you move.

General Notes:

- Apply the shampoo sparingly, as too much shampoo will take longer to rinse off and may leave spots. See “hints” below for areas that may require extra shampoo.
- Two (2) boxes of super concentrate shampoo should yield approximately 700 – 1000 washes.

Bus Cleaning Hints:

- The windows do not require shampoo application. The ACC Eco-Power Brush will wash the windows perfectly and avoid spotting.
- Apply extra shampoo around the fuel cap, tires, tail pipe and under the rear bumper, as these areas tend to collect exhaust, oil, grease and excess road grime.

Trailer Cleaning Hints:

- Apply extra shampoo on rub rails, especially the top rail at front of trailer, as well as all door hardware as these areas tend to collect exhaust, oil, grease and excess road grime.

D128R
11/03

7 GPM - 1:200 - 1:125 - 1:100
7 - 70 psi

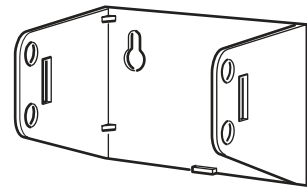
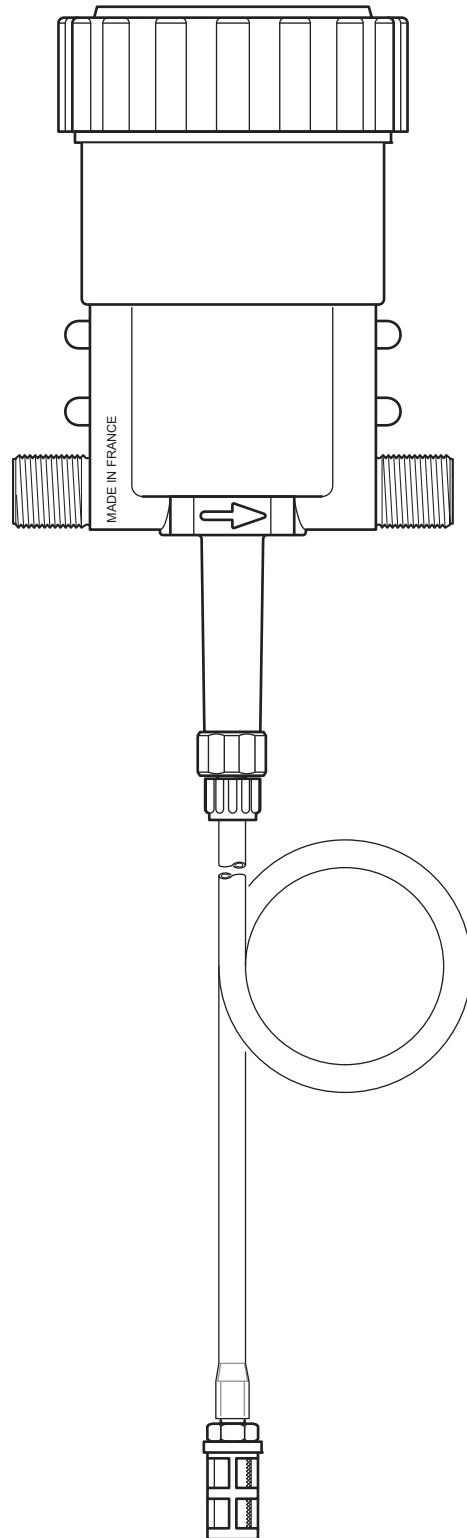

D128R
11/03

7 GPM - 1:200 - 1:125 - 1:100
7 - 70 psi

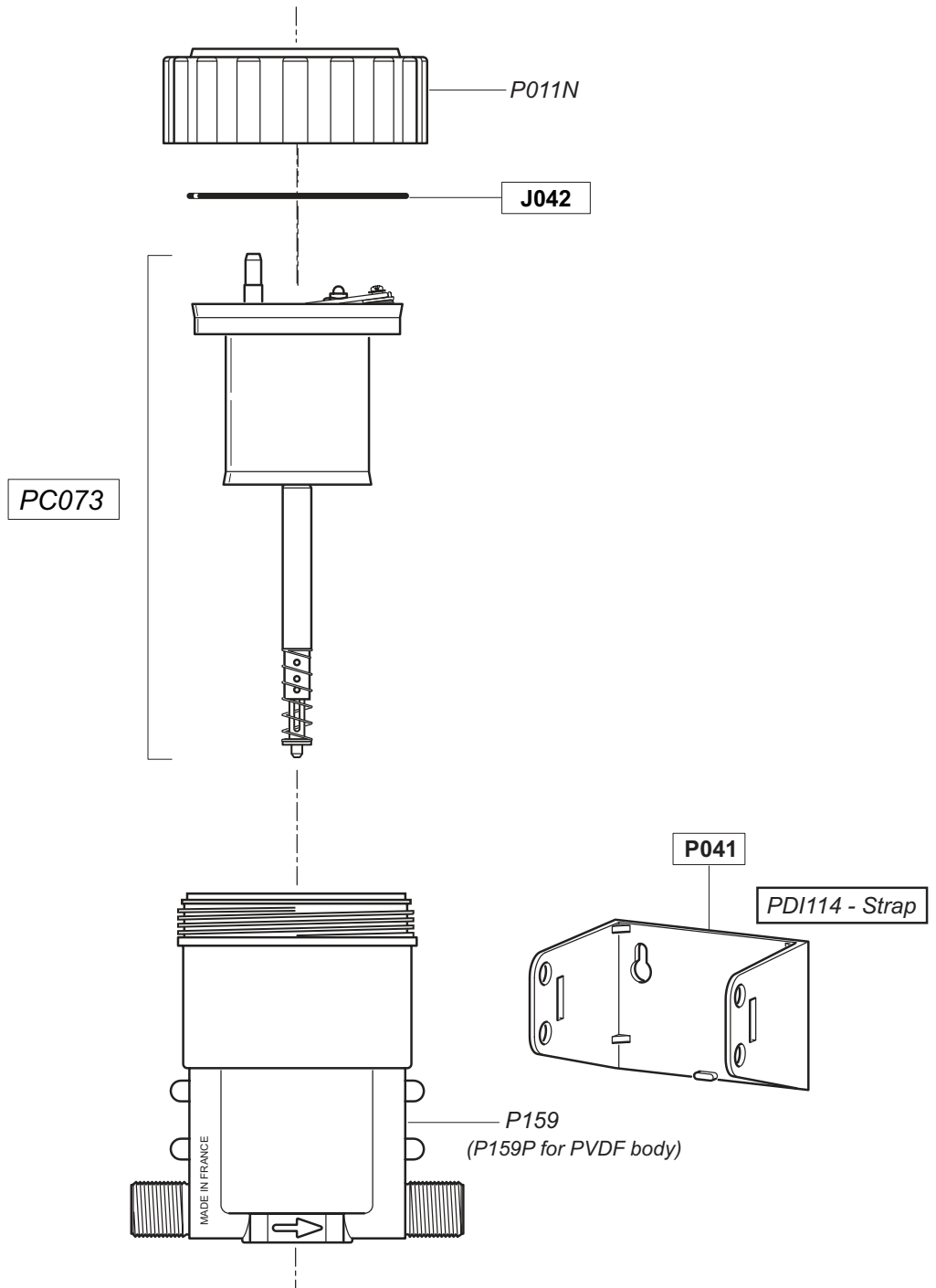

D128R
11/03

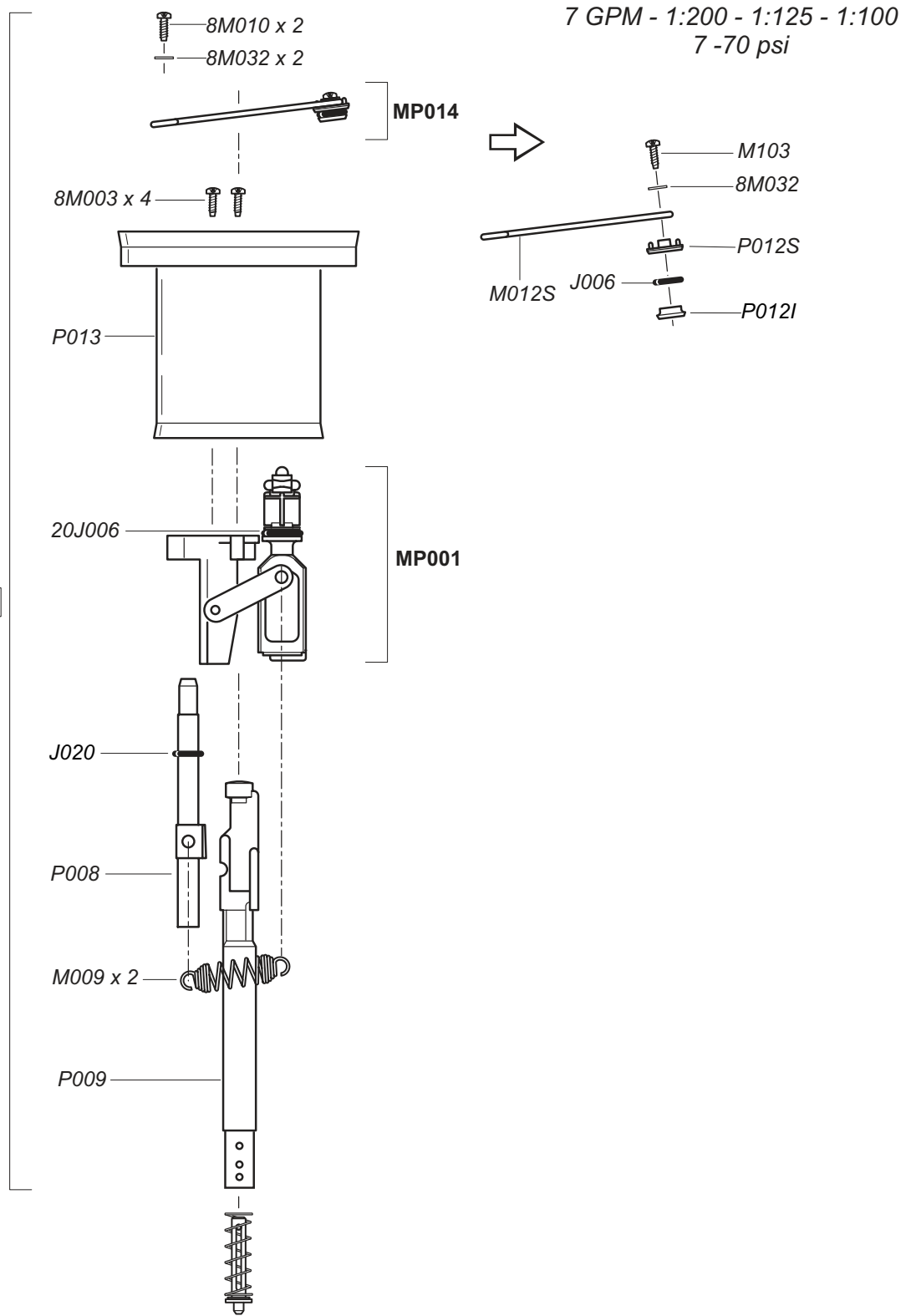

D128R
11/03

7 GPM - 1:200 - 1:125 - 1:100
7 - 70 psi

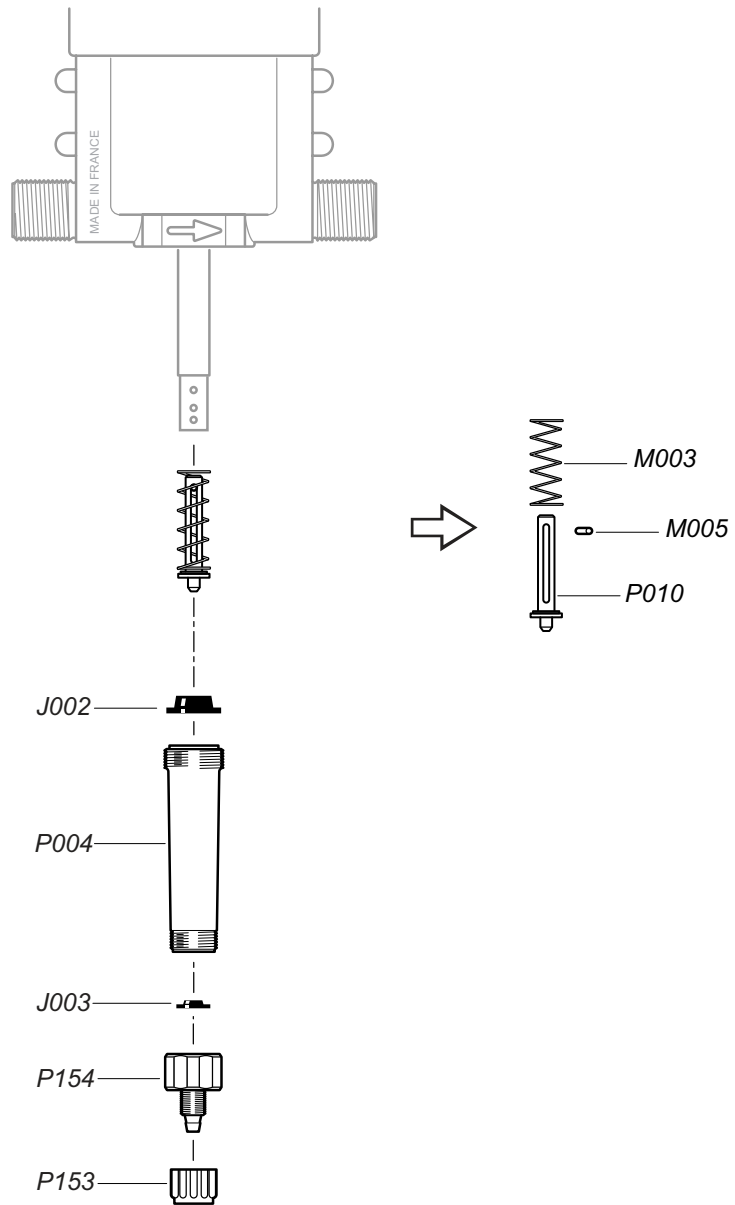

D128R
11/03

7 GPM - 1:200 - 1:125 - 1:100
7 - 70 psi

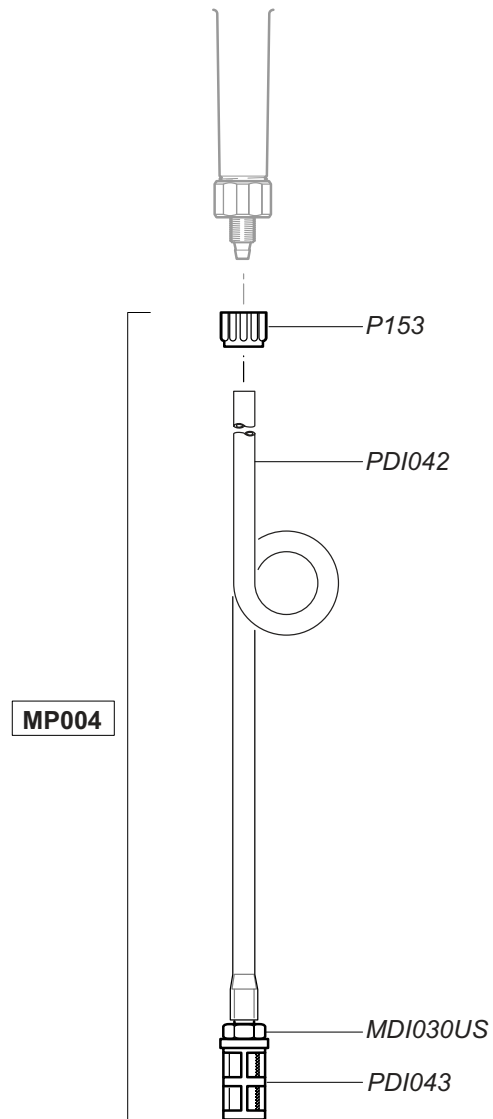

Contact Information:

ACC International Inc.

4640 Falletta Court,

Beamsville, ON

CANADA L0R 1B4

Toll Free: 1.800.265.7405

Telephone: 905.563.1444

Fax: 905.563.4452

Email : info@accint.ca

Web: www.accint.ca

